

BILL OF MATERIAL

MARK	QTY	DESCRIPTION	LENGTH	WEIGHT	REMARKS
19B1	1				
19B1	1	W10X22	8'-2 3/4"	182	A992
a7	2	L2-1/2X2X1/4	0'-10 5/8"	6	A36
ha1	1	BP12"x4" 1/4"	8'-6 9/16"	115	A36
p55	1	PL3/8"x4" 1/2"	0'-6"	3	A36
p57	1	PL3/8"x5" 1/4"	0'-6"	3	A36
p72	2	PL3/8"x2"	0'-2 1/2"	1	A36
p162	1	PL3/8"x2 3/4"	0'-9 3/8"	3	A36
19B2	1				
19B2	1	W16X26	9'-6 3/4"	250	A992
a7	2	L2-1/2X2X1/4	0'-10 5/8"	6	A36
ha3	1	BP12"x4" 1/4"	10'-4 1/2"	139	A36
p55	1	PL3/8"x4" 1/2"	0'-6"	3	A36
p72	2	PL3/8"x2"	0'-2 1/2"	1	A36
TOTAL WEIGHT THIS DRAWING					712

ASSN. NICK	TOTAL QTY	UNIT	FIELD BOOTS	LENGTH	REMARKS
19B1	4	4	3/4" DIA. A35N	1 3/4"	CONNECTION TO WELDED BANK
19B2	8	8	3/4" DIA. A35N	1 3/4"	CONNECTION TO WELDED BANK

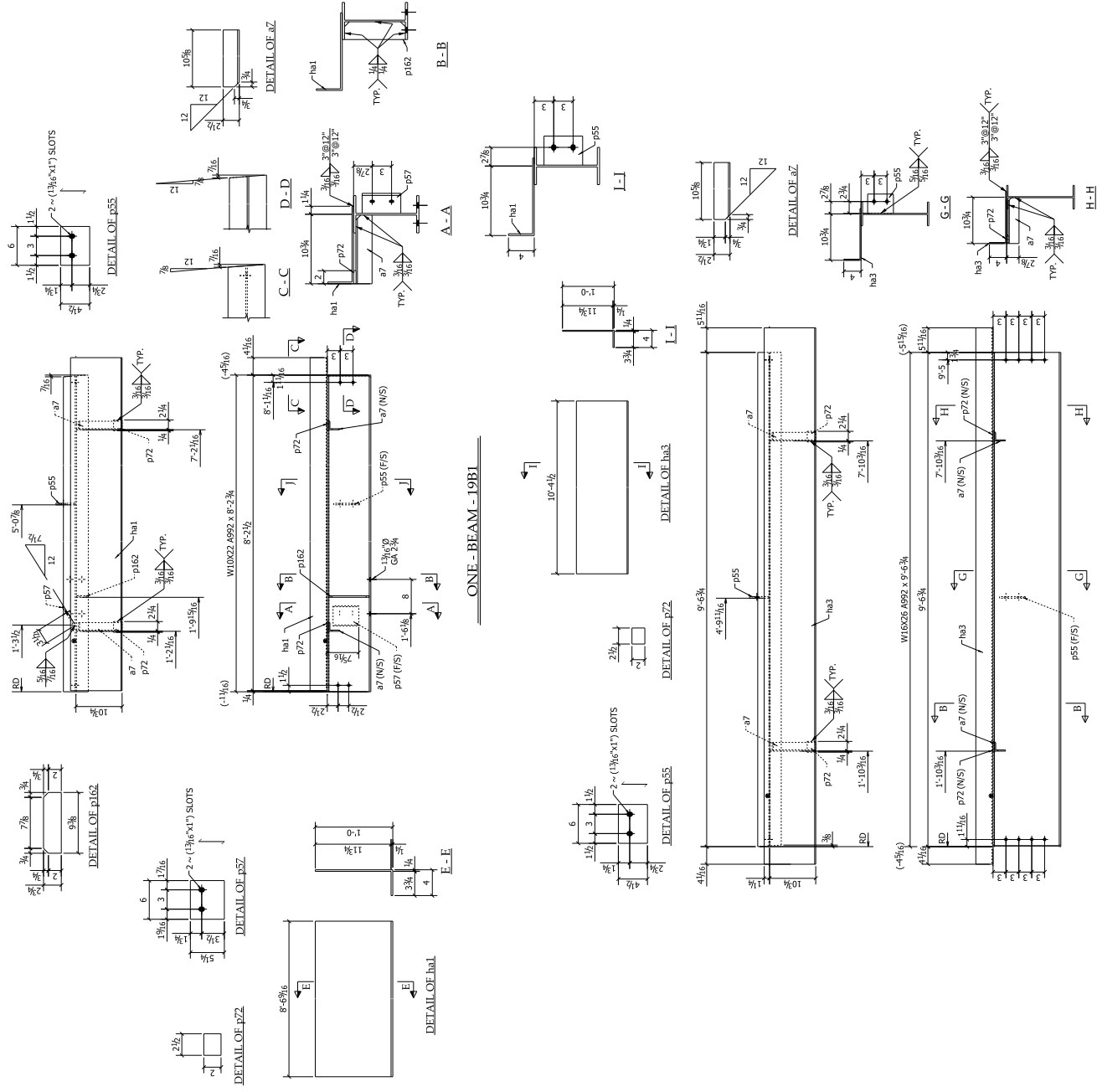

ONE - BEAM - 19B1

ONE - BEAM - 19B2